

"MP" Electric Emitter

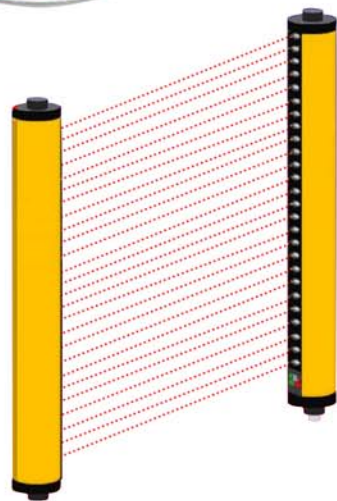

檢測高度	60-1240mm	供電電壓	DC12-24V
截面尺寸	27x29mm	輸出方式	NPN/PNP
檢測距離	0-3m	輸出電流	<100ma
光軸數量	Apr-36	防護等級	IP65
光軸間距	20/40	工作溫度	-10~55°C
紅光外長	940nm	相對濕度	15%-85%
最大功率	<3w	抗撞能力	10g/20ms
響應時間	4-18ms	掃描時間	<18ms

1

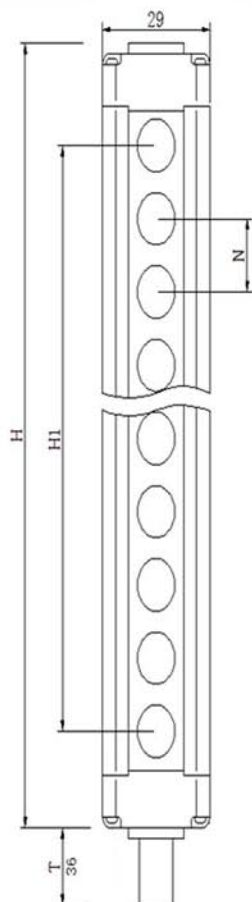
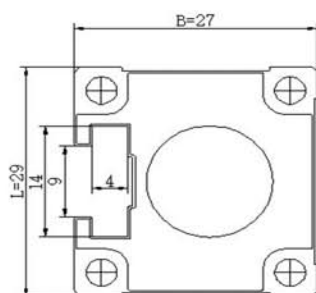

型號	光軸數量	光軸間距	保護高度	外殼高度	檢測距離	輸出方式	外形尺寸
Model	No. of Optic Axis	Pitch	Protect Height	Outer Height	Detect Area	Output	Outer Dimension
		mm	(H1)mm	(H)mm	m		(LxBxH)mm
MP0420	4	20	60	125	0-3	NPN/PNP	29x27x125
MP0620	6		100	165			29x27x165
MP0820	8		140	205			29x27x205
MP1020	10		180	245			29x27x245
MP1220	12		220	285			29x27x285
MP1420	14		260	325			29x27x325
MP1620	16		300	365			29x27x365
MP1820	18		340	405			29x27x405
MP2020	20		380	445			29x27x445
MP2220	22		420	485			29x27x485
MP2420	24		460	525			29x27x525
MP2620	26		500	565			29x27x565
MP2820	28		540	605			29x27x605
MP3020	30		580	645			29x27x645
MP3220	20		620	685			29x27x685
MP0440	4		40	120			190
MP0640	6	200		270	29x27x270		
MP0840	8	280		350	29x27x350		
MP1040	10	360		430	29x27x430		
MP1240	12	440		510	29x27x510		
MP1440	14	520		590	29x27x590		
MP1640	16	600		670	29x27x670		
MP1840	18	680		750	29x27x750		
MP2040	20	760		830	29x27x830		
MP2240	22	840		910	29x27x910		
MP2440	24	920		990	29x27x990		
MP2640	26	1000		1070	29x27x1070		
MP2840	28	1080		1150	29x27x1150		
MP3040	30	1160		1230	29x27x1230		
MP3240	32	1240		1310	29x27x1310		